

# SPECIAL EVENT VENUES

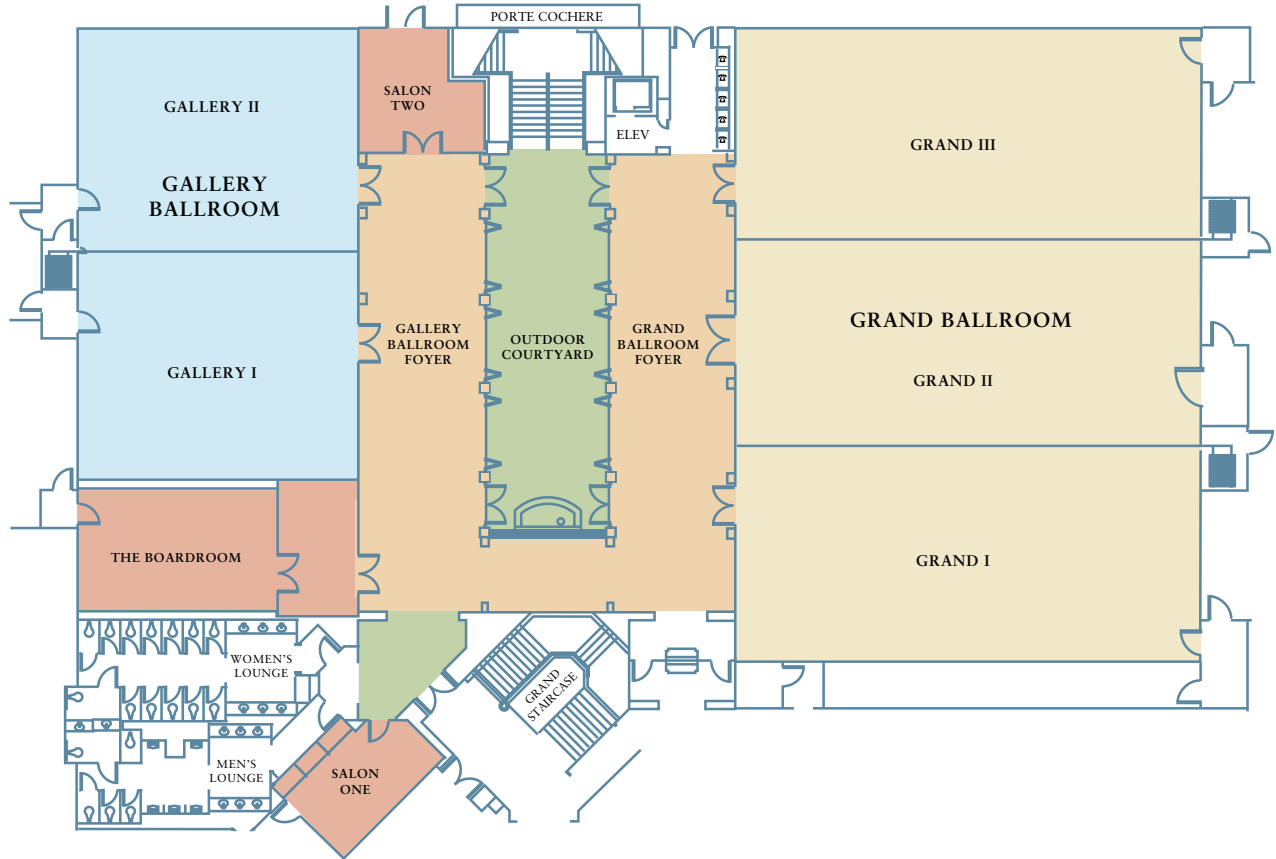

## SIZE & CAPACITY

| ROOM                             | SQ. FT. (APPROX.) | DIM.   | CEILING | THEATER/ RECEPTION | CLASSROOM | RDS. OF 10 | U-SHAPE | CONF | HOLLOW-SQUARE | CRESCENT |
|----------------------------------|-------------------|--------|---------|--------------------|-----------|------------|---------|------|---------------|----------|
| <b>INDOOR FUNCTION SPACE</b>     |                   |        |         |                    |           |            |         |      |               |          |
| GRAND BALLROOM                   | 7,500             | 74x102 | 16      | 800                | 300       | 500        | 180     | n/a  | 200           | 300      |
| GRAND I                          | 2,500             | 74x34  | 16      | 260                | 96        | 160        | 60      | n/a  | 60            | 90       |
| GRAND II                         | 2,500             | 74x34  | 16      | 260                | 96        | 160        | 60      | n/a  | 60            | 90       |
| GRAND III                        | 2,500             | 74x34  | 16      | 260                | 96        | 160        | 60      | n/a  | 60            | 90       |
| GALLERY BALLROOM                 | 3,200             | 72x44  | 12      | 300                | 120       | 220        | 64      | 54   | 72            | 120      |
| GALLERY I                        | 1,600             | 36x44  | 12      | 150                | 60        | 100        | 32      | 30   | 36            | 40       |
| GALLERY II                       | 1,600             | 36x44  | 12      | 150                | 60        | 100        | 32      | 30   | 36            | 40       |
| BOARDROOM                        | 590               | 19x31  | 10      | n/a                | n/a       | n/a        | n/a     | 14   | n/a           | n/a      |
| PACIFIC ROOM (NOT SHOWN)         | 240               | 24x10  | 10      | n/a                | n/a       | n/a        | n/a     | 12   | n/a           | n/a      |
| SALON ONE                        | 400               | 16x25  | 10      | 30                 | 12        | 20         | n/a     | 14   | n/a           | n/a      |
| SALON TWO                        | 250               | 16x16  | 10      | 20                 | 12        | 20         | n/a     | 10   | n/a           | n/a      |
| COURTYARD                        | 1,200             | 16x72  | n/a     | 180                | n/a       | 5          | n/a     | n/a  | n/a           | n/a      |
| GRAND FOYER                      | 1,370             | 19x72  | 10.5    | 120                | n/a       | n/a        | n/a     | n/a  | n/a           | n/a      |
| GALLERY FOYER                    | 1,370             | 19x72  | 10.5    | 120                | n/a       | n/a        | n/a     | n/a  | n/a           | n/a      |
| EXECUTIVE SUITES (2) (NOT SHOWN) | 450               | 27x17  | 8       | 50                 | 20        | 30         | 20      | 20   | 22            | n/a      |
| <b>OUTDOOR FUNCTION SPACE</b>    |                   |        |         |                    |           |            |         |      |               |          |
| PACIFIC LAWN                     | 4,500             | n/a    | n/a     | 400                | n/a       | 35         | n/a     | n/a  | n/a           | n/a      |
| OCEAN LAWN                       | 5,500             | n/a    | n/a     | 250                | n/a       | 25         | n/a     | n/a  | n/a           | n/a      |
| SEAVIEW LAWN                     | 5,300             | 38x140 | n/a     | 250                | n/a       | 25         | n/a     | n/a  | n/a           | n/a      |
| STUDIO LAWN                      | 2,600             | 40x65  | n/a     | 250                | n/a       | 20         | n/a     | n/a  | n/a           | n/a      |





**OUTDOOR LAWNS**

- 1 - Seaview Lawn
- 2 - Studio Lawn
- 3 - Pacific Lawn
- 4 - Ocean Lawn

**BALLROOMS**

- 5 - Grand Ballrooms
- 5 - Gallery Ballrooms

**DINING**

- 6 - The Loft
- 7 - Mosaic Bar and Grille
- 8 - Studio Garden
- 9 - Studio

*Montage*

LAGUNA BEACH

30801 SOUTH COAST HIGHWAY, LAGUNA BEACH, CA 92651

(949) 715-6000 FAX (949) 715-6100

MONTAGEHOTELS.COM/LAGUNABEACH

To preview our other hotels and residential opportunities, visit [montagehotels.com](http://montagehotels.com).