



Weddings
AT MONTAGE LAGUNA BEACH



Celebration

Love really is life's greatest adventure, and Montage Laguna Beach is the perfect location for one of the most important steps in that journey — your wedding. Exchanging vows amid the serene rhythms of the surf, fresh ocean breezes and lush gardens, with 180-degree unobstructed views of the Pacific, you'll create a tapestry of seaside memories that you and your guests will cherish for a lifetime.

We are honored to be a part of your journey.





Ceremonies and Cocktail Receptions

OCEAN LAWN

Up to 400 Guests

With dramatic views of the sparkling Pacific Ocean and striking Laguna Beach coastline, the Ocean Lawn offers a stunning backdrop for gatherings regardless of size. Revel in the moment as you say “I do” in the picturesque seaside setting.

PACIFIC LAWN

Up to 400 Guests

Your guests will be awestruck by a wedding held on the Pacific Lawn of Montage Laguna Beach. With sweeping, unobstructed 180-degree views of the Pacific Ocean, this pristine site is jaw-dropping in its scope and grandeur.



Receptions

GRAND BALLROOM & COURTYARD

Up to 400 Guests

7,500 square feet

Few ballrooms offer elegance for up to 400 guests like the Grand Ballroom. With its dramatic 16-foot ceilings, pre-function promenade foyer and intimate outdoor Courtyard, events can be staged in various configurations, meandering from room to room.

GALLERY BALLROOM

Up to 120 Guests

3,200 square feet

Set a stately yet intimate scene in the tasteful Gallery Ballroom. Ideal for 20 to 120 guests, the venue offers an approachable space that can be reconfigured in a variety of ways to suit a party’s needs, whatever they may be.





Receptions

PACIFIC LAWN

Up to 400 Guests

The Pacific Lawn is the epitome of coastal bliss. Relish 180-degree views of the vast Pacific Ocean and captivating Laguna Beach shoreline while raising a celebratory toast, dining on elevated fare and dancing the night away.

SEAVIEW LAWN

Up to 400 Guests

Indulge the senses while admiring the coastal beauty and splendor visible from the Seaview Lawn. Guests will be enchanted by the charming views of Laguna Beach and the rhythmic waves crashing against the shore below.

Studio Restaurant

Up to 120 Guests

Sitting atop a 50-foot bluff overlooking the Pacific Ocean, Studio offers a breathtaking setting for sizeable parties seeking an oceanfront ceremony or reception venue.

Large windows wrapping around the entire restaurant provide an abundance of natural light and views to the glistening ocean beyond.

As the resort's signature restaurant, Studio features modern California coastal cuisine and is available to buyout. Restaurant buyouts offer complete use of the Studio lawn, patio, fire pit and main and private dining rooms.



Venue Locations



OUTDOOR LAWNS

- 1 - Seaview Lawn
- 2 - Studio Lawn
- 3 - Pacific Lawn
- 4 - Ocean Lawn

BALLROOMS

- 5 - Grand Ballrooms
- 5 - Gallery Ballrooms

DINING

- 6 - The Loft
- 7 - Mosaic Bar and Grille
- 8 - Studio Garden
- 9 - Studio

Special Event Venues

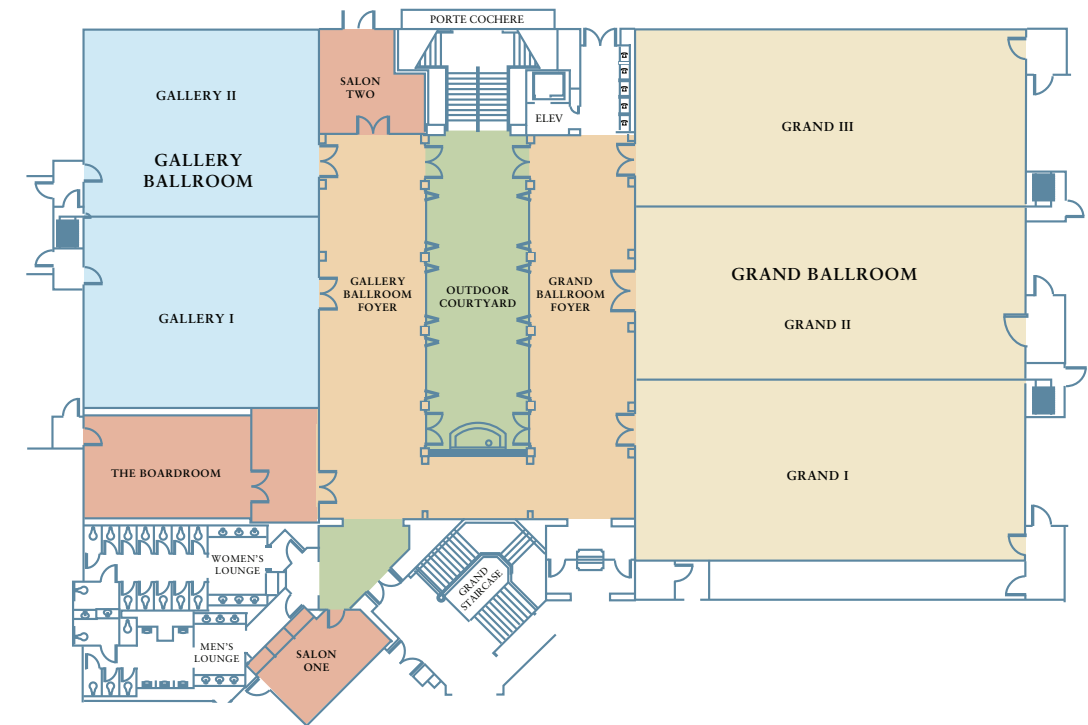

SIZE & CAPACITY

ROOM	SQ. FT. (APPROX.)	DIM.	CEILING	THEATER/ RECEPTION	CLASSROOM	RDS. OF 10	U-SHAPE	CONF	HOLLOW-SQUARE	CRESCENT
INDOOR FUNCTION SPACE										
GRAND BALLROOM	7,500	74x102	16	800	300	500	180	n/a	200	300
GRAND I	2,500	74x34	16	260	96	160	60	n/a	60	90
GRAND II	2,500	74x34	16	260	96	160	60	n/a	60	90
GRAND III	2,500	74x34	16	260	96	160	60	n/a	60	90
GALLERY BALLROOM	3,200	72x44	12	300	120	220	64	54	72	120
GALLERY I	1,600	36x44	12	150	60	100	32	30	36	40
GALLERY II	1,600	36x44	12	150	60	100	32	30	36	40
BOARDROOM	590	19x31	10	n/a	n/a	n/a	n/a	14	n/a	n/a
PACIFIC ROOM (NOT SHOWN)	240	24X10	10	n/a	n/a	n/a	n/a	12	n/a	n/a
SALON ONE	400	16x25	10	30	12	20	n/a	14	n/a	n/a
SALON TWO	250	16x16	10	20	12	20	n/a	10	n/a	n/a
COURTYARD	1,200	16x72	n/a	180	n/a	5	n/a	n/a	n/a	n/a
GRAND FOYER	1,370	19x72	10.5	120	n/a	n/a	n/a	n/a	n/a	n/a
GALLERY FOYER	1,370	19x72	10.5	120	n/a	n/a	n/a	n/a	n/a	n/a
EXECUTIVE SUITES (2) (NOT SHOWN)	450	27x17	8	50	20	30	20	20	22	n/a
OUTDOOR FUNCTION SPACE										
PACIFIC LAWN	4,500	n/a	n/a	400	n/a	35	n/a	n/a	n/a	n/a
OCEAN LAWN	5,500	n/a	n/a	250	n/a	25	n/a	n/a	n/a	n/a
SEAVIEW LAWN	5,300	38x140	n/a	250	n/a	25	n/a	n/a	n/a	n/a
STUDIO LAWN	2,600	40x65	n/a	250	n/a	20	n/a	n/a	n/a	n/a

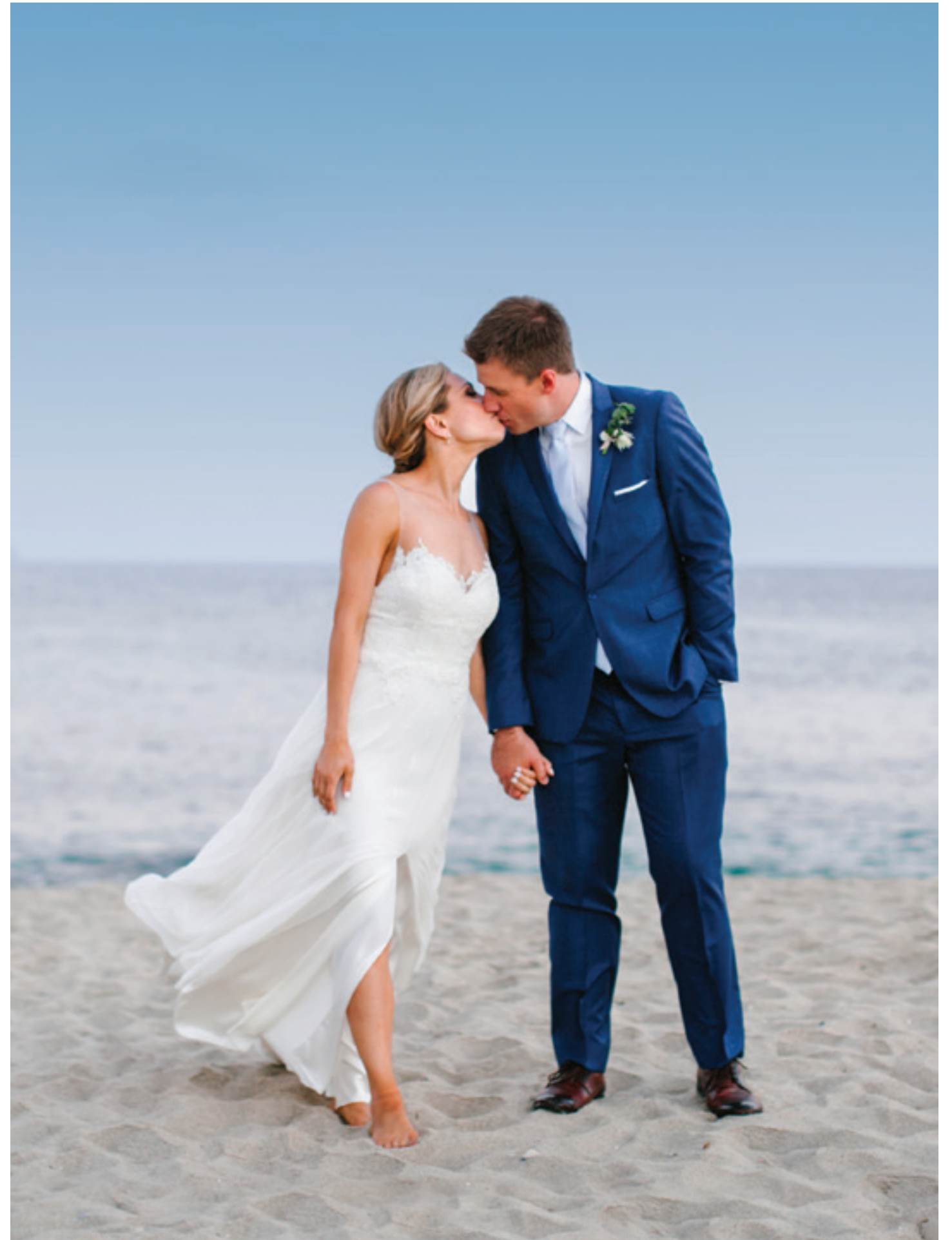



Private Dining: Studio

STUDIO PRIVATE DINING ROOM

- The largest private dining space at Studio, the Private Dining Room boasts panoramic views of the Pacific Ocean and includes a private patio for a reception
- The Private Dining Room accommodates up to 30 guests. Additional private dining rooms can be combined to accommodate larger parties
- Available Tuesday through Sunday from 5:00pm until 10:00pm

STUDIO CHEF'S TABLE

- Premier dining experience at Studio with an exclusive view of the kitchen
- The Chef's Table boasts Chef Ben Martinek's special six-course tasting menu with wine pairings
- The Chef's Table accommodates up to 14 guests
- Available Tuesday through Sunday from 5:00pm until 10:00pm

STUDIO SUNSET ROOM

- Seats up to 40 guests
- Semi-private space offering exquisite sunset views
- Wraparound view of the ocean
- Available Tuesday through Sunday from 5:00pm until 10:00pm

Private Dining: The Loft and Mosaic Bar and Grille

LOFT PRIVATE DINING ROOM

- The largest private dining room in the resort, this space accommodates up to 70 guests and features stunning views of the ocean with floor-to-ceiling windows
- Featuring creative American cuisine, The Loft offers options to please all palates
- Situated on the fourth floor, The Loft offers an elevated perspective of the resort grounds and panoramic ocean vistas beyond

THE LOFT NORTH PATIO

- The Loft Patio can be used exclusively for a breakfast, lunch or dinner or as a pre-event venue for cocktail or hors d'oeuvres reception
- This outdoor patio space accommodates up to 30 guests
- Shade is provided by awnings and heaters are included based on weather conditions

MOSAIC BAR AND GRILLE

- Accommodates 50 guests seated or up to 100 guests in a reception style configuration
- Outdoor venue with ocean views
- Built-in bar



Cuisine

Creative cuisine that inspires and delights is an essential element of every Montage Laguna Beach wedding celebration. Our master chefs are well versed in the art of creating custom menus and cakes that reflect your personal taste. Menus feature organic ingredients from small family farms and rare artisanal producers. To enhance your dining pleasure during your reception, our accomplished wedding Sommelier will suggest custom wine pairings from our extensive cellar to accompany each course. Together, the culinary team at Montage Laguna Beach will create a dining masterpiece for your seaside wedding.



Accommodations

Montage Laguna Beach is located on 30 oceanfront acres in the heart of the picturesque artists community of Laguna Beach, California, midway between Los Angeles and San Diego. Designed to capture the charm and artistic heritage of this quaint seaside village, our craftsman-style resort features 253 guestrooms, suites and beach-style bungalows. Capturing the relaxed elegance of an oceanfront residential estate, the resort harmonizes with its rugged coastal location, serving as the perfect backdrop for celebrations big and small. Crafted in a serene color palette reflecting its coastal surroundings, each guestroom features an ocean view with outdoor relaxation space on balconies or patios, marble bathrooms including separate shower and soaking tub, signature Montage bedding and linens and estate quality furnishings.

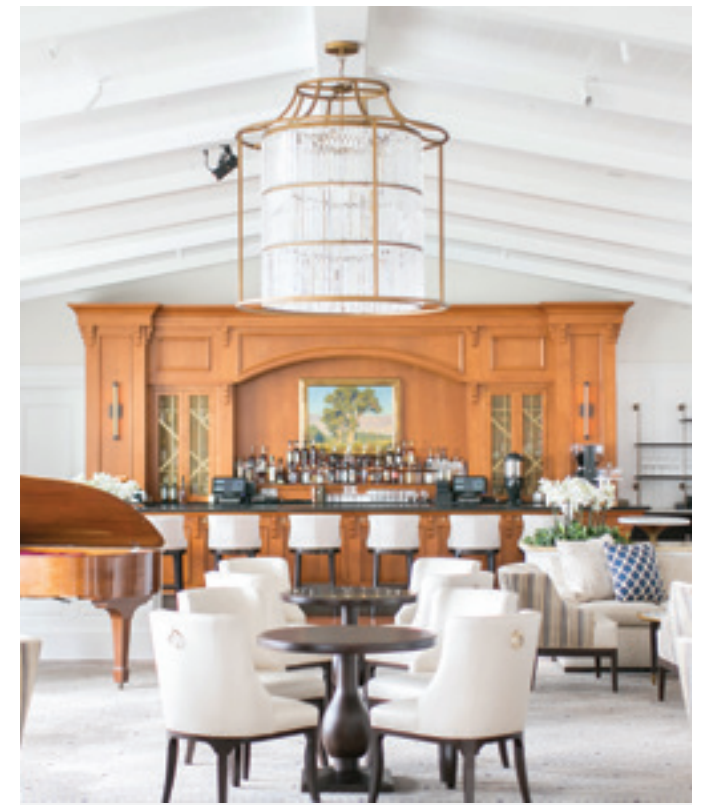



Spa Montage

Immerse yourself in our oceanside sanctuary at Spa Montage where you and your guests can prepare for your grand occasion. Signature experiences incorporate the elements of this healing and abundant environment, and combine them with highly skilled and innovative techniques, personalized for your needs.

Our mission is to support you in achieving your beauty and wellness goals through an exceptional palette of spa therapies, beauty treatments and wellness offerings – all inspired by our oceanfront environment. With 21 treatment rooms and amenities that include eucalyptus steam rooms, dry redwood saunas, whirlpools and exclusive access to an ocean-front saltwater lap pool and lounge deck, Spa Montage is designed to answer every need.



BRIDAL PACKAGES

A special celebration calls for something out of the ordinary. Allow our dedicated team of Spa Montage specialists deliver a one-of-a-kind experience for you and your wedding party.

SALON

Our full-service Salon is here to pamper you and your bridal party in preparation for your special day. Their team of stylists specialize in wedding day hairstyles, nails and makeup to complete your look.

MOVEMENT STUDIO AND FITNESS CENTER

From high-intensity cardio to calming yoga, a wide array of classes are offered daily. Our team of talented instructors would love to arrange private classes for individuals or groups for dedicated attention to your fitness needs.

COMPASS SPORTS

Compass Sports is a year-round adventure and activities hub for outdoor enthusiasts of all ages. From guided hiking tours and bike rentals to stand up paddleboard excursions and snorkeling, our Compass Sports team is here to provide highly personalized experiences for you and your guests.

*A destination
renowned for
incomparable
moments that last
a lifetime.*

When your big day arrives, you — and you alone — command the attention of all of our Montage associates, leaving you free to cherish the big and little moments of your day. From artful settings to custom menus, every detail reflects your personal style. A promise is made — set against the backdrop of the Pacific Ocean surrounded by loved ones.

A romantic reception sets the stage for celebrating with family and friends. Every moment is rich with love, beauty and memories you will treasure for a lifetime.

